

erbe

location

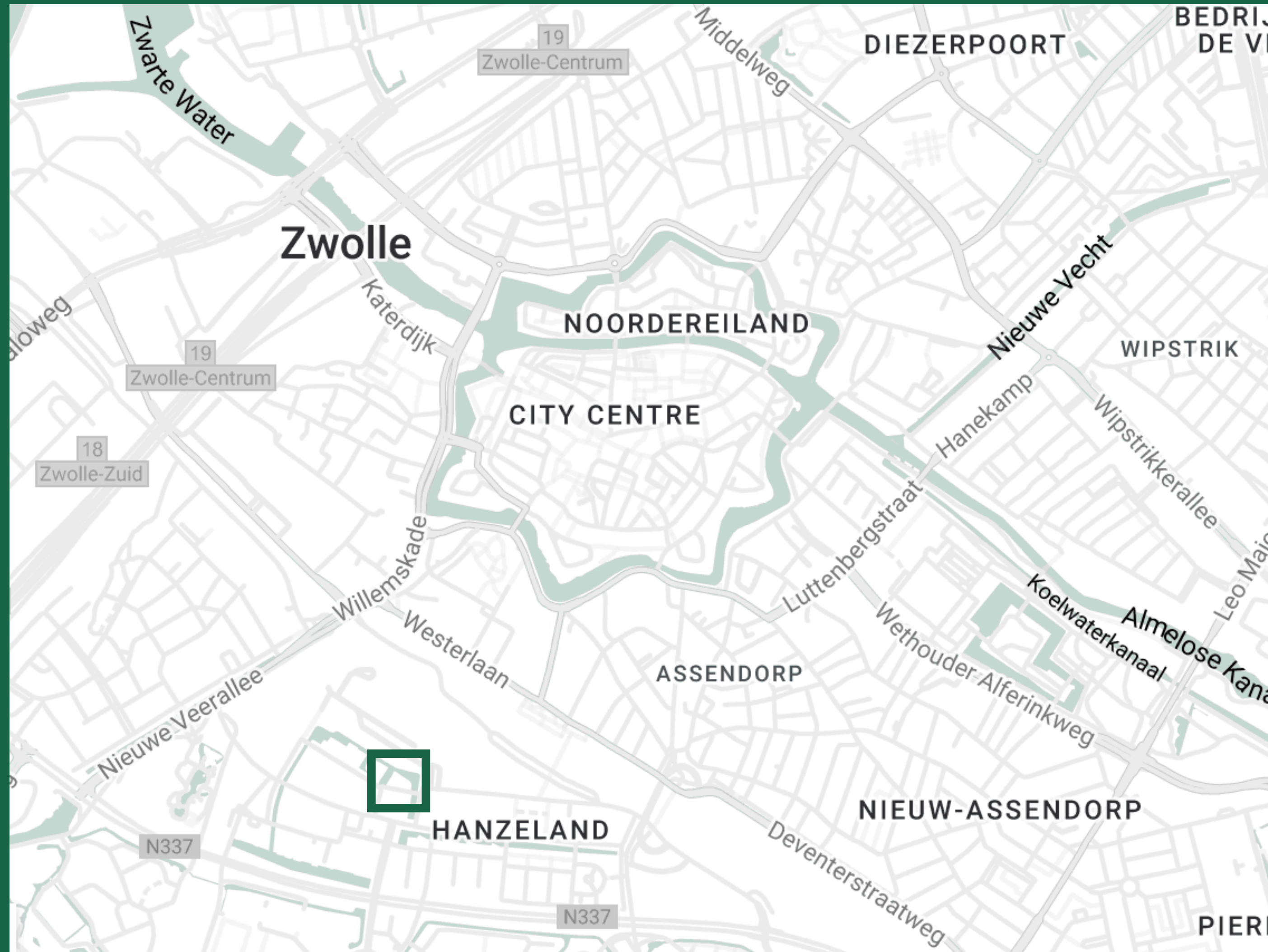



spoorzone

businesses

trash chutes

station

schools

residential

parking

businesses

businesses

police

police

businesses

view from my bedroom window



= stake out point

divide between private & public

many forms of transport pass here

easily accessible

traffic differs at every hour

i cross the cube frequently
driving in or out, or bringing away trash



pictures
of the
cebe



cube view

i live here!!

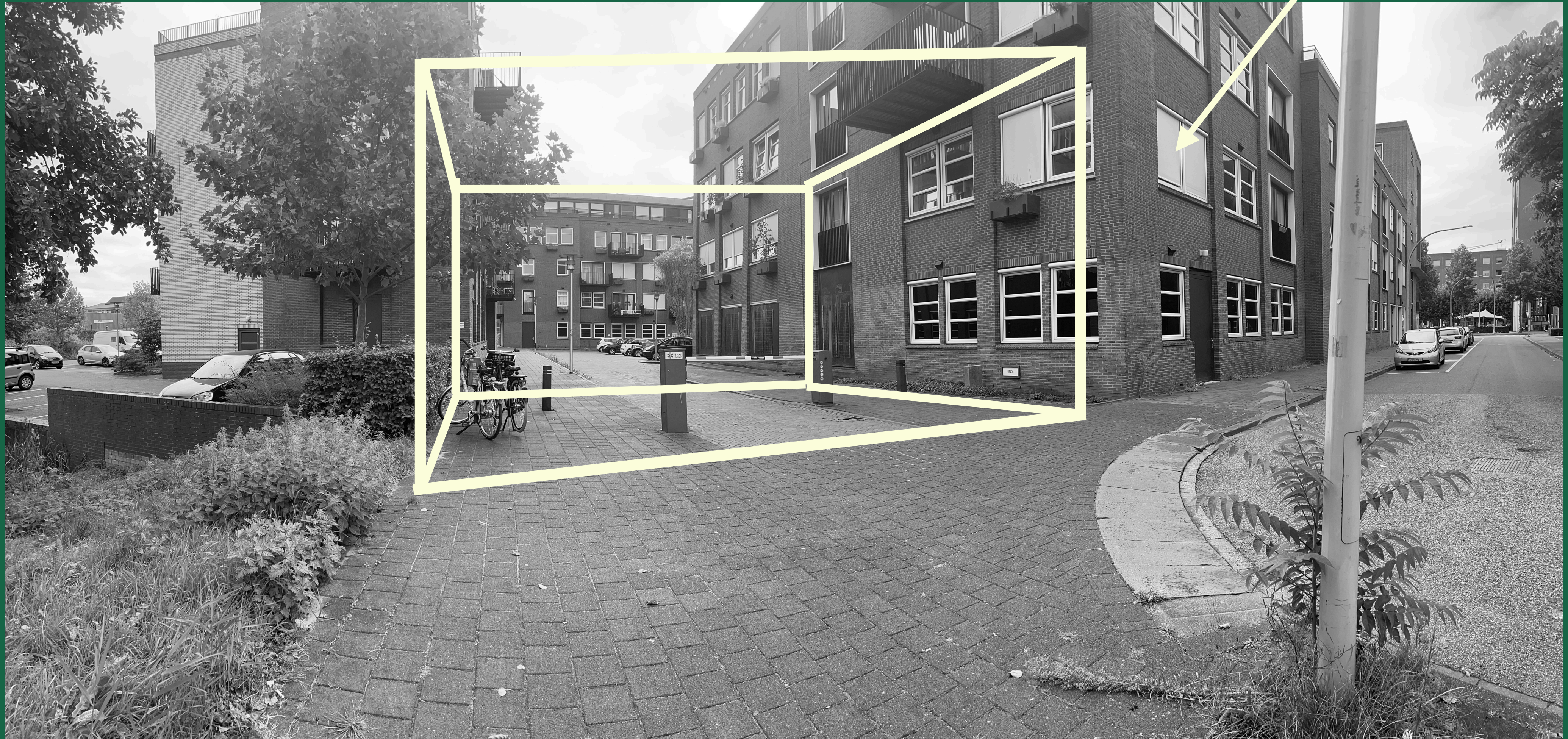

a day in the life
of the
cette



drawings
of the
cube

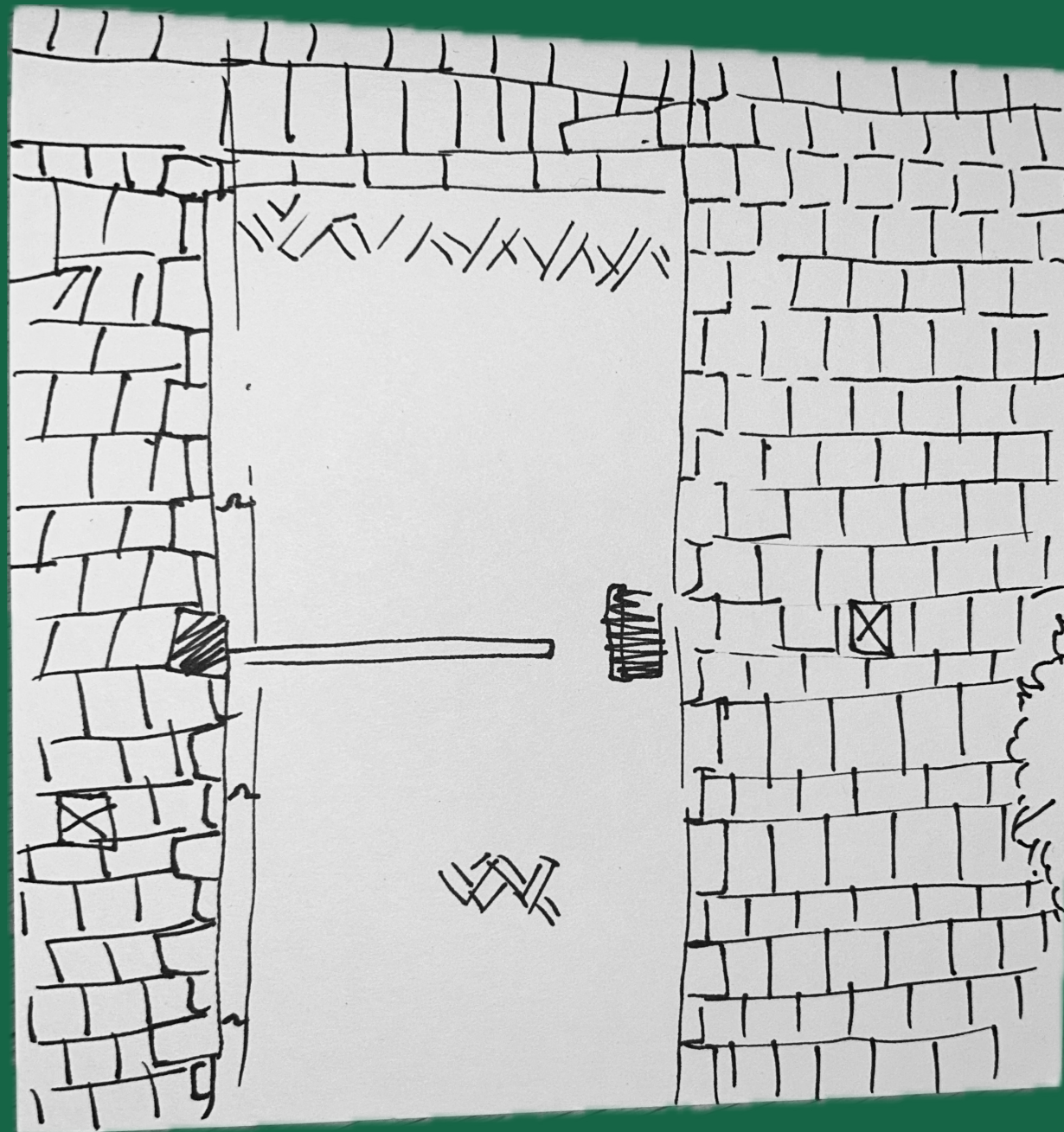

**birds eye
from memory**

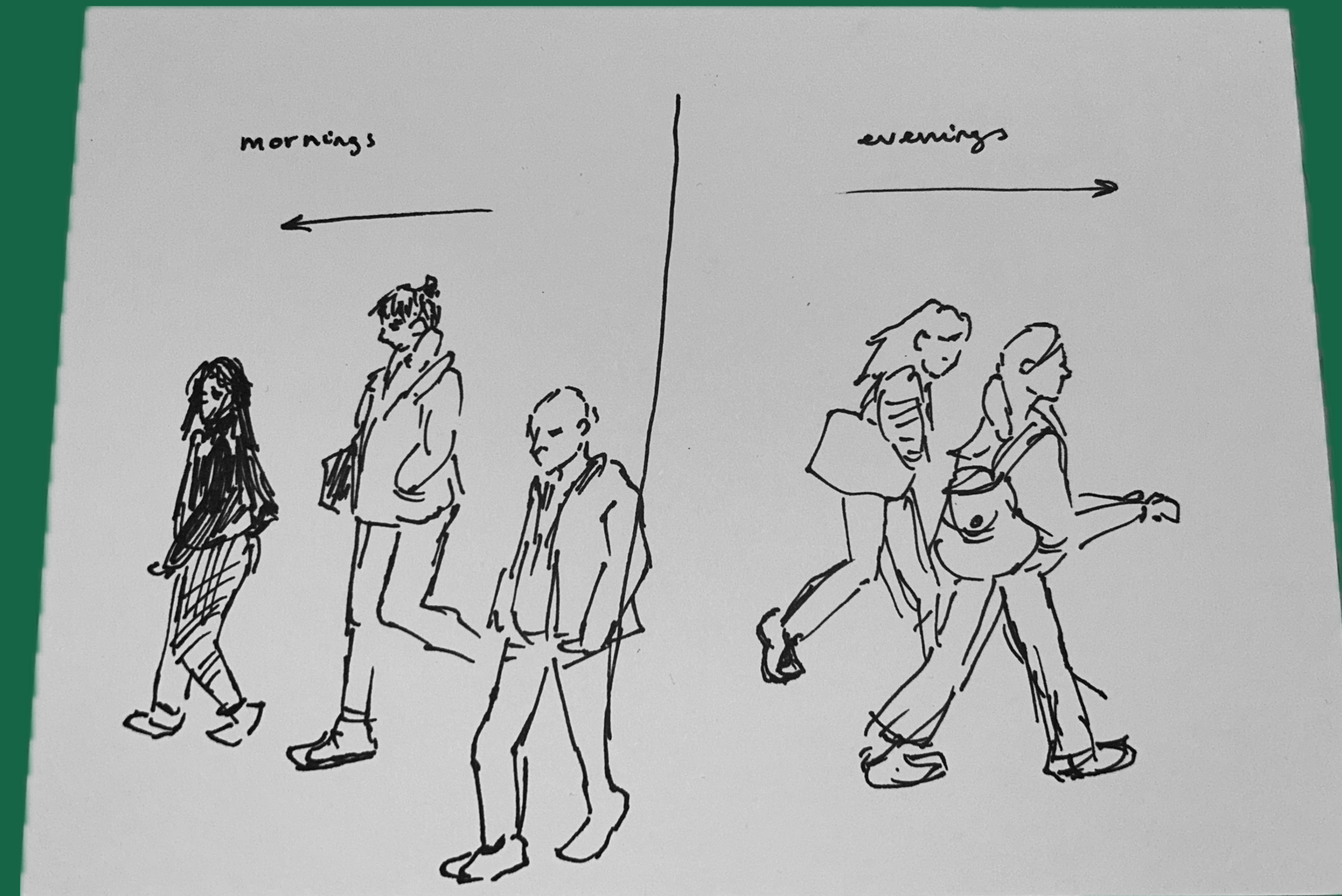

**people &
movement**

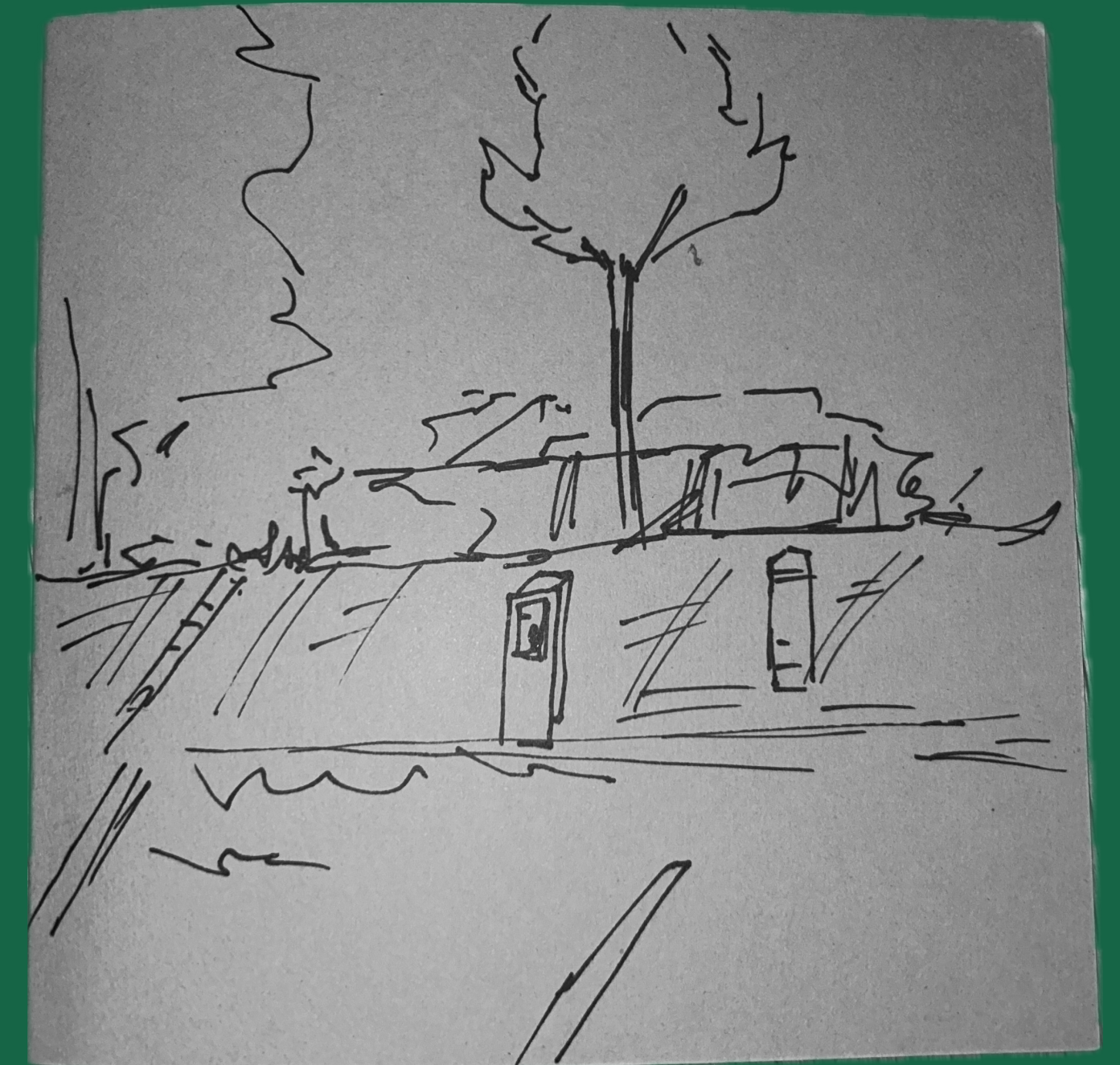

**bedroom
view**

notes of the cube

at 2am i woke
up to noise
- 2 kids on scooters
arguing

my cube acts like the
tide, a little.

in the morning people
rush in, in the evening
they rush out

the same girls park
in the cube every school day
one is always early
the other always
late. they leave
together, chatting.

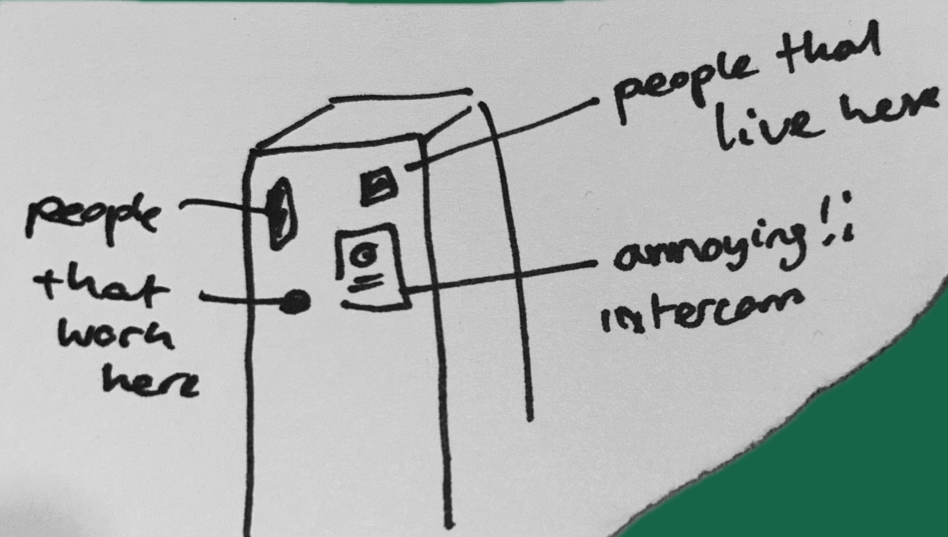

i cant decide if
my cube is partially private
or entirely public.
only cars are stopped
sometimes, i guess

on the 19th, there
was a techno festival.
many partygoers passed
by

patterns
of the

cube

brick zigzag



stacked grid



measurements
of the
carbe

1,5 rotations on the
pedals of my bike
across

8 long steps across

approx. 1,5 cars

one long throw

23 tiny steps across

about 14 footballs

4 seconds of driving
and 12 seconds of
attempting to open
the parking gate
across

about 14 footballs

textures
inside the

cebbe

pavement



mossy brick
(less walked on)



permanently
inside the
cebbe



1556 x
bricks



1088x
pavement tiles



1 x
parking gate
& intercom



14 x
sidewalk border



2 x
sidewalk post



8-10 x
waving branches



89 x
overgrown twigs from plantbeds

types of people
inside the
cebe

festivalgoers

students

office workers

dog walkers

residents

paths taken

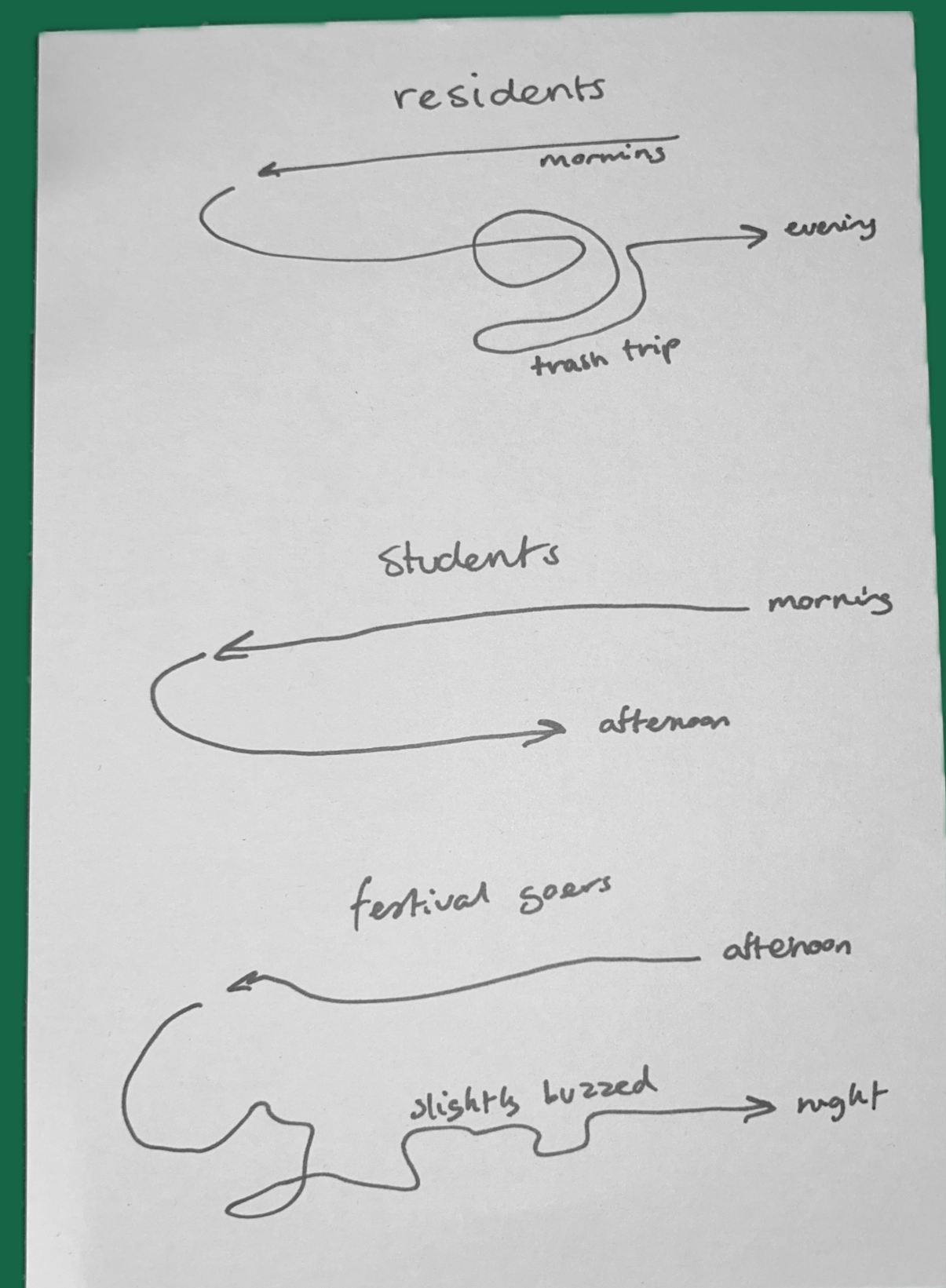

sometimes...

inside the

cebbe



scooters

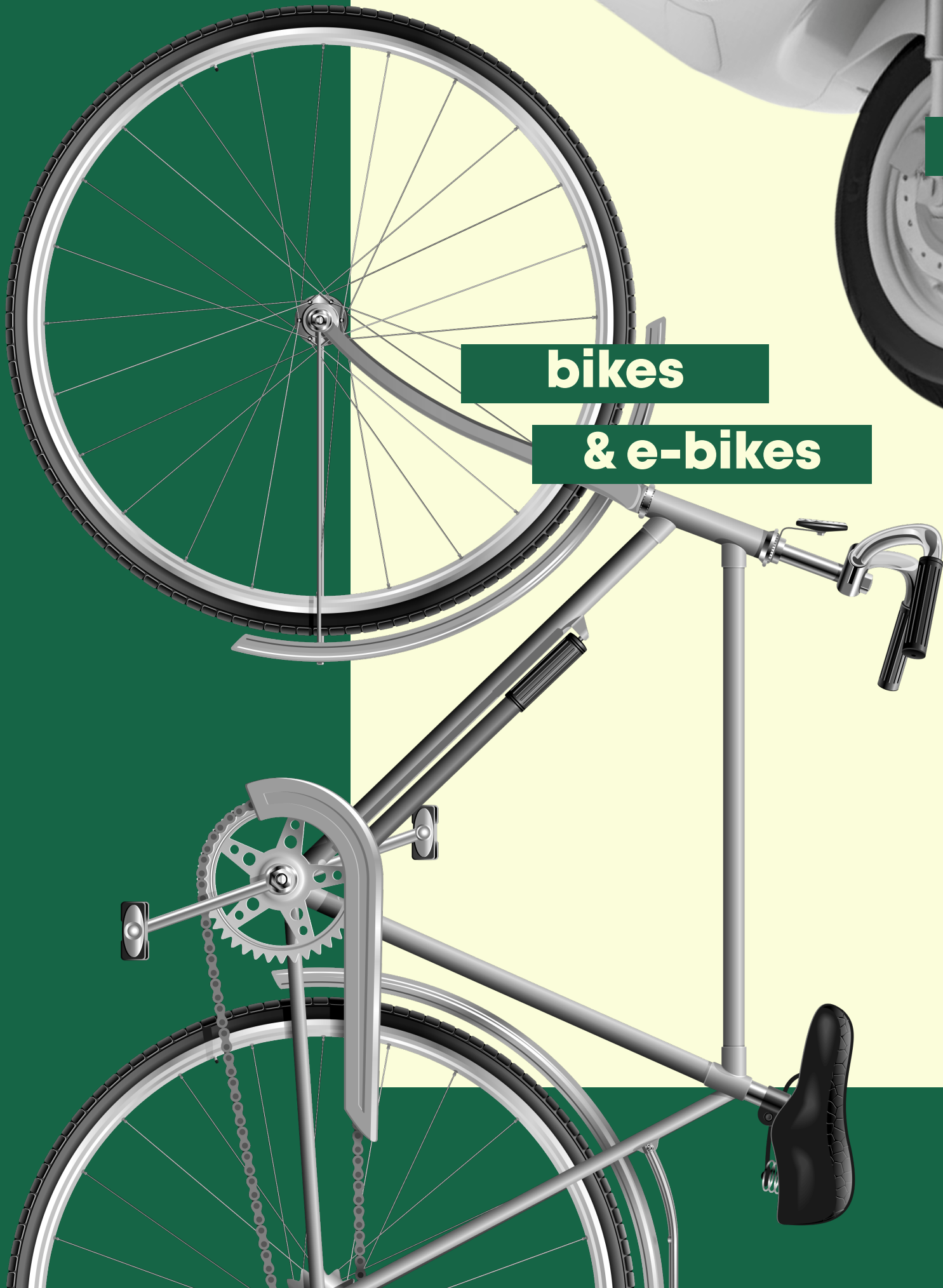

bikes

& e-bikes



trashbags



many, many feet



a few dogs on a walk



residents of the pond



cars

also sometimes...

inside the

cebbe



music



dangling keys



conversations



full backpacks



conflict

& impatience

unfinished tasks of the cube

times I moved through this cube:
riding into the parking lot 10/9/24 at 16:35
bringing away trash 10/9/24 at 19:46
returning from trash dump 10/9/24 19:48
i forgot to track the rest |

shadows change by the minute, maybe track them on a day off

amounts of times the intercom was used during recordings

cars passing through/ in or out at what times?

people moving from the train station can probably be correlated with bus times & train times ; how long does it take them to get here & what trains / busses did they take